

First Floor

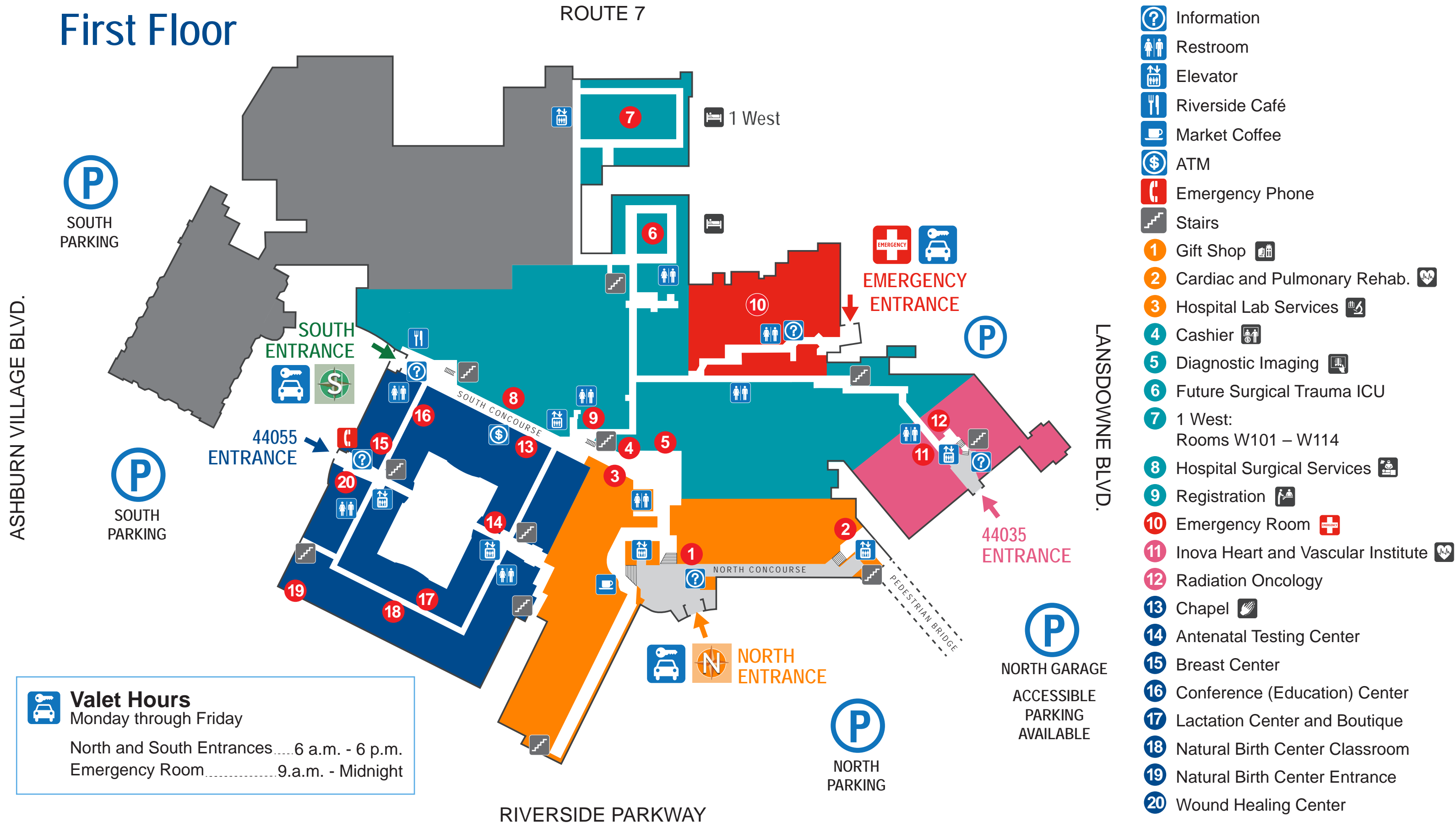

Valet Hours
Monday through Friday
North and South Entrances.....6 a.m. - 6 p.m.
Emergency Room.....9.a.m. - Midnight

Second Floor

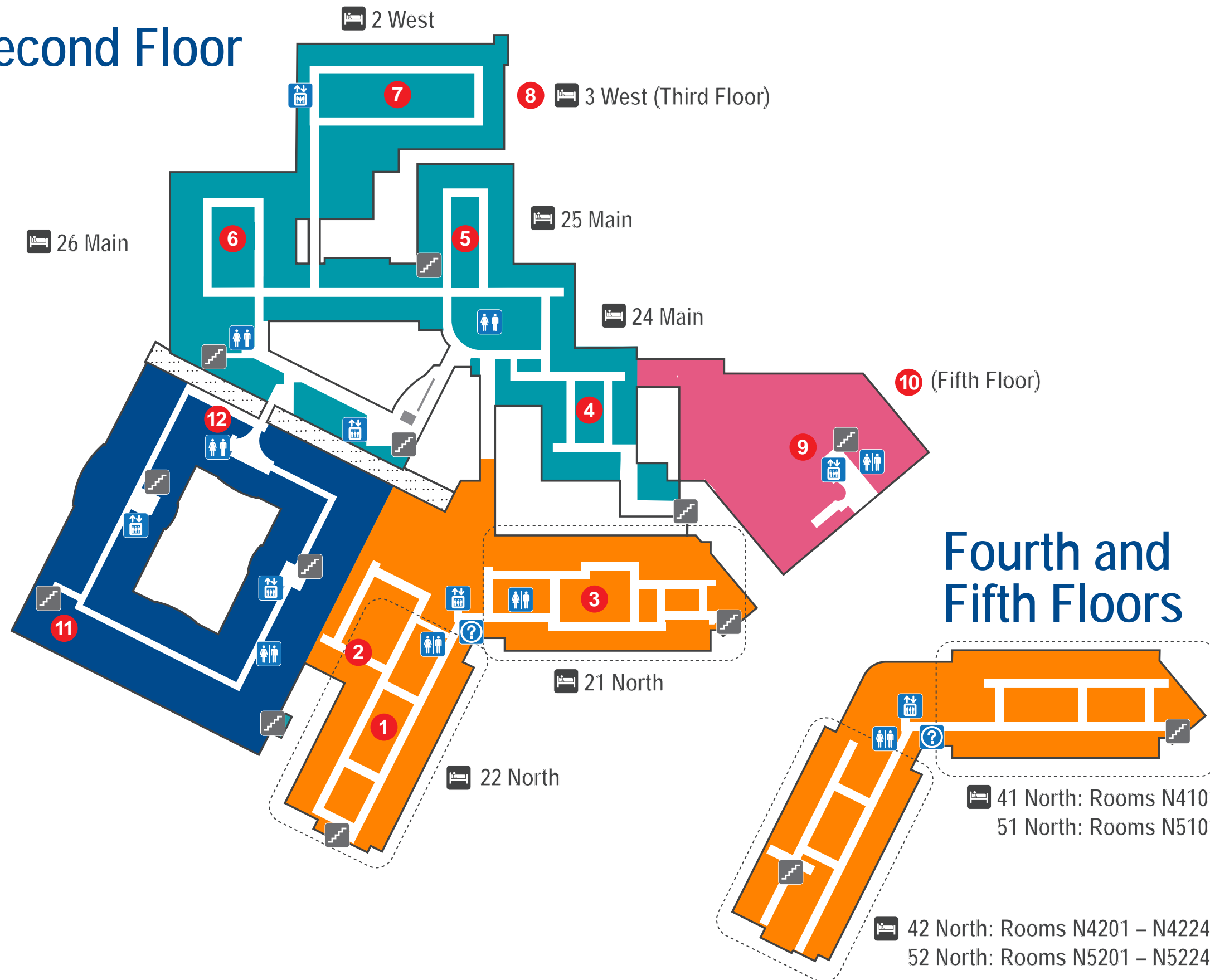

- Information
- Restroom
- Elevator
- Emergency Phone
- Stairs
- 1 22 North: Labor and Delivery Rooms N2201 – N2216
- 2 22 North: OB Emergency Dept.
- 3 21 North: NICU Rooms N2101 – N2116
- 4 24 Main: Rooms M205 – M230
- 5 25 Main: Rooms M231 – M245
- 6 26 Main: Rooms M247 – M274
- 7 Intensive Care Unit (ICU)
- 8 3 West: Rooms W301 – W314
- 9 Loudoun Ambulatory Surgery Center
- 10 Outpatient Rehabilitation – Fifth Floor
- 11 Inova Cares Clinic for Women
- 12 Hospital Administration

Fourth and Fifth Floors

- 41 North: Rooms N4101 – N4124
51 North: Rooms N5101 – N5124
- 42 North: Rooms N4201 – N4224
52 North: Rooms N5201 – N5224